



VEGA TEMPERATURE CHANGING

LED luminaire for under cabinet lighting

Materials:

aluminium, polycarbonate

Finishes:

aluminium, black matt

Light source:

twin LED module

Connector:

Micro24

Wiring:

2000mm

Application type:

under cabinet, under shelf **Installation:**
on surface

VEGA D-MOTION is an aluminium luminaire just 5 mm thick integrating a twin LED cluster (2700 – 4000 K) with diffused light projection and LGP (Light Guide Plate) diffuser that cancels the spot effect. **VEGA D-MOTION** is available in two configurations, both supplied with two-pole power cable and Micro24 connector: **TWA (Tunable White) without sensor** and **WHC (White Changeable) SDM (Sense Dimmer Master)** with static colour temperature sensor wired master, with on-off function and brightness dimmer for adjusting individual luminaires or all those connected to it.

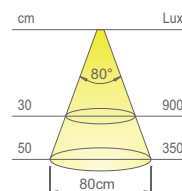
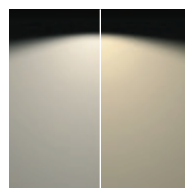

Colour appearance	Tunable White
Colour temperature	2700 - 4000 Kelvin
Luminous flux	300 lm
Luminous efficiency	60 lm/W
CRI	Ra ≥ 80





VEGA TWA SDM WHC



with touchless dimmer master switch

Watt & Volt

5W @ 24Vdc

CONVERTER NOT INCLUDED. TO BE ORDERED SEPARATELY.



Finish

aluminium

black matt

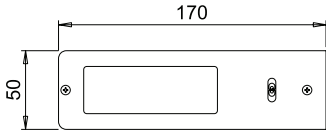

VEGA TWA



without switch

Watt & Volt

5W @ 24Vdc

CONVERTER AND TWA SELECTOR NOT INCLUDED. TO BE ORDERED SEPARATELY.



Finish

aluminium

black matt

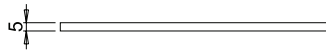
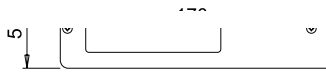

White Changeable (WHC) SDM (Sensor Dimmer Master) luminaires in the D-MOTION collection integrate a sensor for static colour temperature selection of the luminaire (2700 K or 4000 K) as well as on/off and brightness control functions.



Tunable White (TWA) luminaires of the D-MOTION collection allow the static or dynamic colour temperature selection (2700 - 4000 K) by a remote selector supplied separately.

FINISHES



ALUMINIUM (code 05)



BLACK MATT (code 32)